

Technical data sheet

SA006 1101 12624 V3

ONDULINE EASYFIX®

Material/Application

EN 534:2010 - Corrugated bitumen sheets

- Category S

DOP: 06-002 2016-12-12



Technical characteristics

Length (m)	L	200 cm	[-0.4 ; +2] cm
Width (m)	W	82 cm	± 1.5 cm
Thickness	t	2.6 mm	[+/-10 %]
Heigh of corrugation	H	38 mm	± 2 mm
Pitch of corrugation	P	96 mm	
Product surface		1.64 m ²	
Weight of product	(PPHR)	4.40 kg	[± 0.31 kg]
	(INTENSE)	4.50 kg	[± 0.32 kg]
Weight/ sqm	(PPHR)	2.68 kg m ²	[+/-10 %]
	(INTENSE)	2.74 kg m ²	[+/-10 %]
Nb of corrugations		6/5	
Sequence		144 mm	

Mechanical & physical properties

Bending under downward load	> 700 N/m ²
Impact strength	250 mm
Tearing strength	≥150 N
Water impermeability	Pass ¹
Proportion of bitumen	> 40%
Homogeneity	Pass ²
Water absorption	< 20%
Recycled content	50 % ³

Durability

Water impermeability after ageing	Pass ¹
Tearing strength after ageing	≥ 150 N
Thermal coefficient	< 100.10-6 1/K

1 No drop of water underneath sheet after 48 hours

2 No area larger than 1 cm² without bitumen

3 ICC-ES VAR Environmental Report VAR-1016 - independant third party official report

Fire resistance

Reaction to fire – EN 13501-1	E
External fire performance – EN 13501-5	Froof

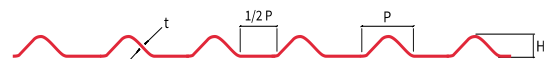

Intense colors

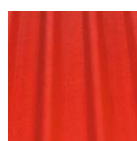

Intense Red



Intense Black



Intense Green



Intense Brown



Intense Anthracite
Grey

Matte colors

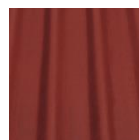

Red



Black



Green

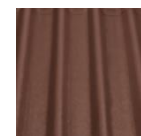

Brown

Installation

Special conditions of installation are required.
Refer to the installation guide.



Warranty

All the claims will be considered with respect to application recommendations issued by Onduline company, see terms and conditions.

Tariff code - HS: 68079000

This TDS was made based on currently available information. Product was made in accordance with above mentioned parameters, but producer/distributor can't anticipate any future change as well as change of regulations. It is the consumer's responsibility to use the product in accordance to producer/ distributor recommendations and his needs. All the claims will be considered with respect to application recommendations issued by Onduline company. See terms and conditions: <https://www.onduline.com/en/terms-and-conditions>

onduline.com

5-7 rue Frédéric Clavel -
FR – 92150 Suresnes

Onduline®
Lightweight roofing systems

Installation in few and easy steps

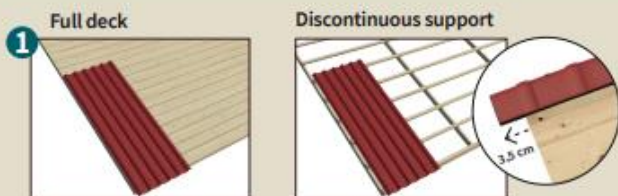

Start laying sheets over the gutter with 3,5 cm overhang maximum. Installation could be realized either on full deck (recommended) or on discontinuous support (every 37 cm).



Lay sheets in the opposite direction to the prevailing winds. Stagger the rows, by starting the second row with a half sheet. Ensure easily the waterproofing by aligning the two overlapping lines.

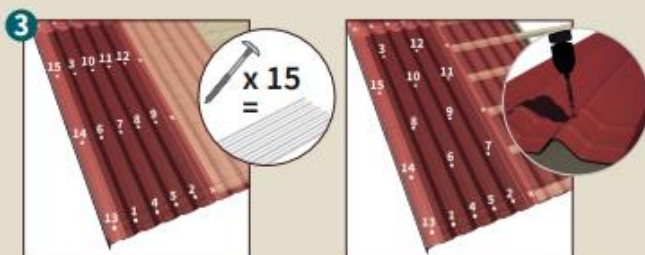

Full deck

Discontinuous support

15 fixings minimum should be used per sheet. The fixing, always set in the top of corrugations, should be done in the right order and in between the two overlapping lines. Wait to fix the last corrugation until you overlap it with the verge element or the next sheet.

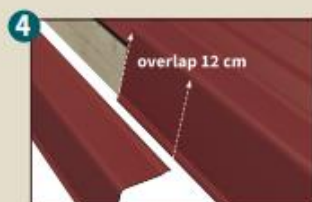

The aesthetics and wind uplift protection can be optimized by using the verge element accessory, which is fixed first on the sidewall, then as well on the top of the corrugation.

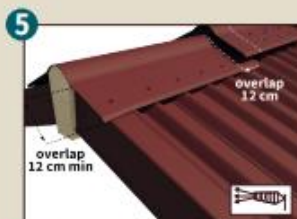

Cover the ridge with the standard ridge and fix it on each side of the roof, on top of each corrugation. The direction of the overlap is opposite to the direction of the prevailing winds.

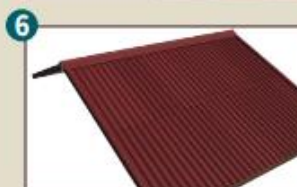

ONDULINE EASYFIX® sheets provide an attractive, colored and long lasting finishing to a wide variety of garden buildings.

Optimise installation & avoid waste combining ONDULINE EASYFIX® COMPACT (1 m) with ONDULINE EASYFIX® (2 m).

Installation on full deck is also highly recommended.

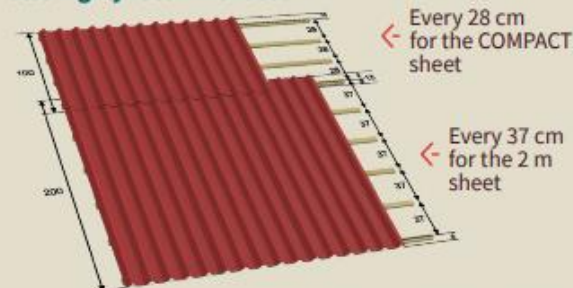

On discontinuous support, **carefully watch the purlin spacing** for optimized durability of the roof.

How to cut and trim your product?



You can easily cut the sheets with roofers cutter, or with hand or mechanical saw.

FOR MORE INFORMATION



Watch the installation video!