

CARTRIDGE FILTER CLEANING

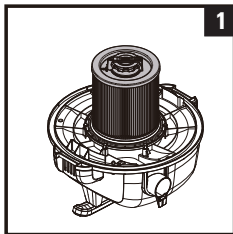

Turn the power head upside down.

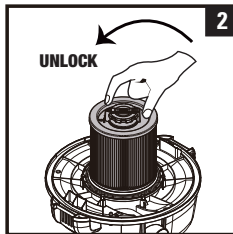

Turn the filter cap counter-clockwise to loosen and remove.

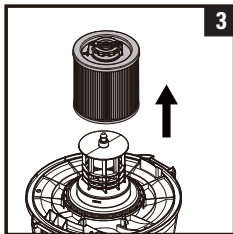

Slide the cartridge filter off the filter cage.

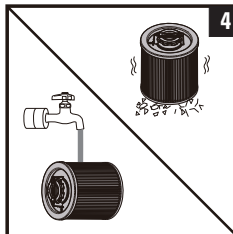

Shake or brush off excess dirt, or rinse (from the inside of the filter) with water.

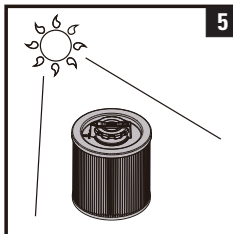

Dry completely (approximately 24 hours), and reinstall.

CARTRIDGE FILTER INSTALLATION

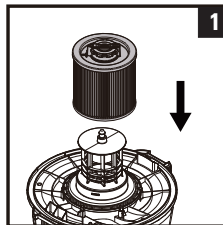

Turn the power head upside down.

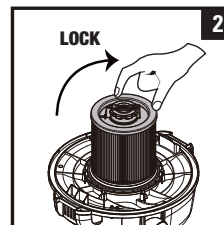

Turn the handle on the filter cap clockwise to tighten and lock the filter into place.

FOAM FILTER INSTALLATION FOR WET PICK-UP ONLY

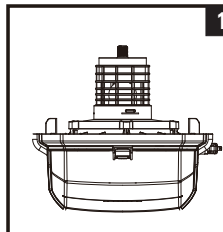

Turn the power head upside down.

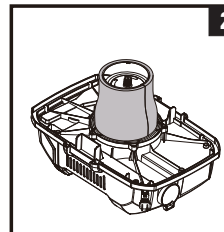

Slide the foam filter down over the filter cage.

FILTER GUIDE

⚠ WARNING

1. Never operate the vacuum without filters installed.
2. To reduce the risk of injury, user must read instruction manual before operating product.
3. Always disconnect the plug from the wall outlet before removing the tank cover.

NOTE:

1. If the cartridge filter has been used for wet pick up, it must be cleaned and dried before dry pick up. A clean cartridge filter may be used for vacuuming small amounts of liquid. For best results when vacuuming large amounts of liquid, remove the cartridge filter and any disposable or reusable dust filters. Install the foam filter. Installing the foam filter will help to protect the motor and minimize the potential for misting that may appear in the exhaust air or dripping of liquid around the lid.
2. The cartridge filter is factory assembled.
3. Accessories included are subject to different models. Please refer to the manual for accessories that are included.